

## 92-S-62(25) - SPEEDLINE System Data Sheet - Version V1 (24-10-23)

SPEEDLINE 92mm 'C' Stud Partition @600mm Ctrs,  
with 2x Siniat GTEC 15mm Fire Board each side,  
25mm APR

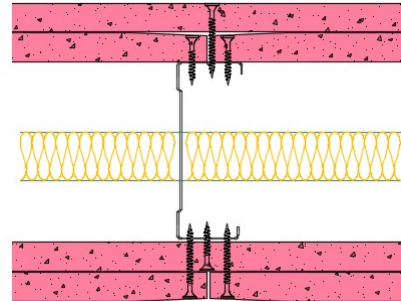

### System Performance Breakdown

Fire Resistance:

BS476 Part 22:1987:

Test Ref & Date or Applied Ref & Report:

Max Height:

Thickness:

Duty Grade: BS 5234: Part 2:1992:

Sound Insulation:

120/120 Minutes (Integrity/Insulation).

**BTC 17593FA - BRE Report P102396-1011C**

Refer to Speedline Specification Clause

**154 mm.** (At Base Track, Excluding Finishes)

**Severe - Annexes A-F**

**53  $R_w$ dB**, Date Tested or Assessed Against - 70-S-62(25)

Test Code:  
H17960AA  
Test Date:  
29/10/2012

Freq. Hz	R dB
50	28.3
63	15.3
80	12.9
100	27.8
125	30.9
160	40.1
200	45.9
250	49.0
315	51.7
400	53.8
500	56.4
630	60.0
800	62.1
1 000	63.9
1 250	62.3
1 600	62.5
2 000	53.2
2 500	48.4
3 150	52.1
4 000	54.7
5 000	56.8
6 300	
8 000	
10 000	

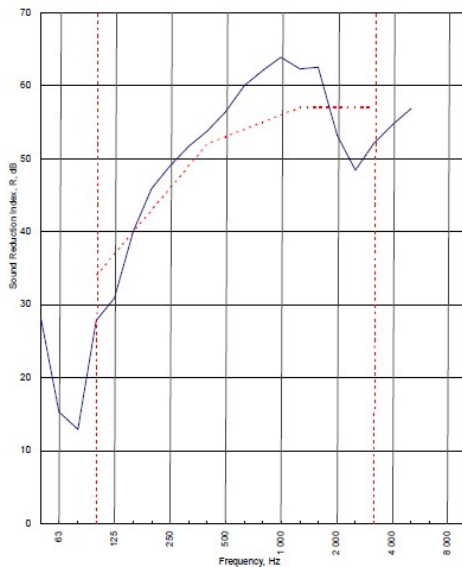



Rating according to BS EN ISO 717-1:1997  
 **$R_w$  (C;Ctr) = 53 (-2;-8) dB**  
 Max dev. 8.6 dB at 2 900 Hz

$C_{50-1100}$ = -9 dB	$C_{50-5000}$ = -8 dB	$C_{100-5000}$ = -2 dB
$C_{1,600-150}$ = -21 dB	$C_{1,600-5000}$ = -21 dB	$C_{1,100-5000}$ = -8 dB

TESTED AT ONE OF THE UKAS ACCREDITED LABORATORIES BELOW

B.T.C (H-Ref on Graph) 

B.R.E 

AIRO 

S.R.L 



Customer: Metsec plc Hepssec Division

BTC 17960A: Page 9 of 11

